

THIS DRAWING IS SUPPLIED FOR INFORMATION ONLY. DESIGN FEATURES, SPECIFICATIONS AND PERFORMANCE DATA SHOWN HEREON ARE THE PROPERTY OF THE AMPHENOL CORPORATION. NO RIGHTS OF REPRODUCTION ARE IMPLIED. ALL DIMENSIONS ARE SUBJECT TO NORMAL MANUFACTURING VARIATIONS.

Customer Drawing

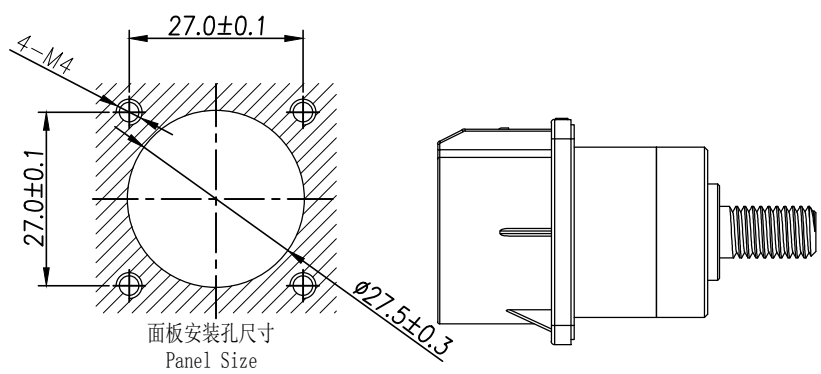

REVISIONS					
REV	ZONE	ECO	DESCRIPTION	DATE	BY APPR
A	--	--	Add dimentions	--	RW EC
C	--	--	Add recommended fasten torque on rear stud	08/13/15	RW EC
D	--	--	Change Dust Cap & Fasten Torsion	06/23/16	RW GX
E	--	--	ADD T Key Model	08/01/18	ST JL

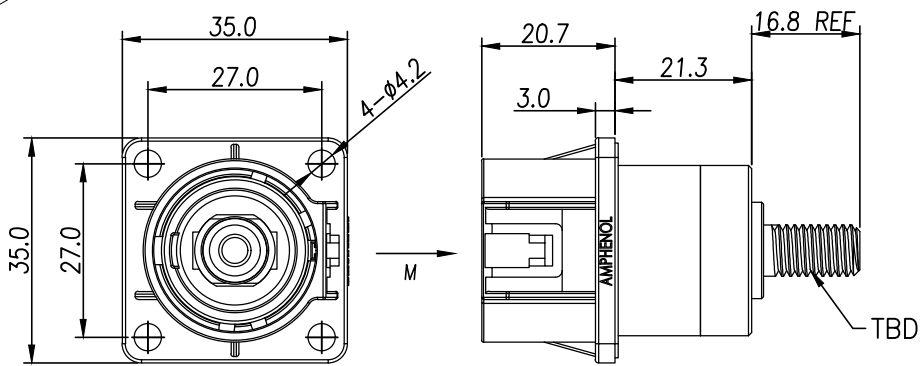
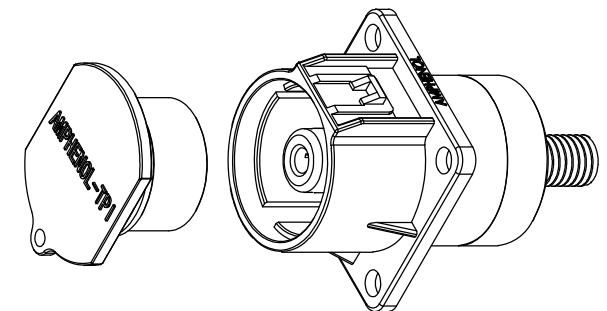

M10 Screw Standard Part List

P/N	Model NO.	Polarization
AC-HA000573	PL00X-300-20M10	X
AC-HA000574	PL00Y-300-20M10	Y
AC-HA000575	PL00U-300-20M10	U
AC-HA000576	PL00V-300-20M10	V
AC-HA000577	PL00W-300-20M10	W
AC-HA001387	PL00T-300-20M10	T

M8 Screw Standard Part List

P/N	Model NO.	Polarization
AC-HA000596	PL00X-300-20M8	X
AC-HA000597	PL00Y-300-20M8	Y
AC-HA000598	PL00U-300-20M8	U
AC-HA000599	PL00V-300-20M8	V
AC-HA000600	PL00W-300-20M8	W
AC-HA001390	PL00T-300-20M8	T

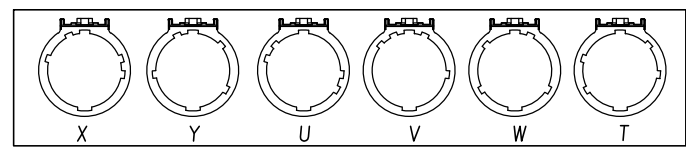

M方向键位示意图

规格参数 (Spec.):

1. 工作温度 Operating temperature: -40° C~+125° C.
2. 额定电流 Current rating: 300 A.
3. 额定电压 Operating voltage: 1000 VDC.
4. 耐电压 Dielectric withstanding voltage: 5000 VDC.
5. 防护等级 Protection class: IP67 & IP2X.
6. 电磁屏蔽 Shielding.
7. 机械寿命 Mating cycle: 500 Min.
8. 带自动二次锁扣 Automatic secondary lock.
9. 铜排推荐安装扭矩 Recommended Fasten Torque on Rear Stud:
M6 : 3.6~4.4 Nm
M8 : 7.2~8.8 Nm
M10: 17.1~20.9 Nm
10. 法兰盘螺丝安装扭矩 Screw Assembly Torque on Flange : 1.6~2.4 Nm

订购信息 Ordering Information

PL00 X - 300 - 20 M10

键位及颜色 Key & Color	螺纹 Thread
"X", 橙色 Orange	M10
"Y", 黑色 Black	M8
"U", 黄色 Yellow	
"V", 绿色 Green	
"W", 红色 Red	
"T", 蓝色 Blue	

	Amphenol Technical Products International GZ				
	第三角投影 THIRD ANGLE PROJECTION	页面 SHEET	幅面 SIZE	版次 REV.	比例 SCALE
签名 SIGNATURE	日期 DATE	UNLESS OTHERWISE SPECIFIED			DWG NO:
制图 DRAWN	Steven	1 of 1	A3	E	PL00-300-20
审核 CHECKED		1) All dimensions are in metric(mm). 2) Tolerances are as follows:			CUST PART #:
批准 APPROVAL		0 PL DEC ±1.00 1 PL DEC ±0.50 2 PL DEC ±0.20			N/A
		Angles ±1°			CUST REV.:
					-

THIS DRAWING IS SUPPLIED FOR INFORMATION ONLY. DESIGN FEATURES, SPECIFICATIONS AND PERFORMANCE DATA SHOWN HEREIN ARE THE PROPERTY OF THE AMPHENOL CORPORATION. NO RIGHTS OF REPRODUCTION ARE IMPLIED. ALL DIMENSIONS ARE SUBJECT TO NORMAL MANUFACTURING VARIATIONS.

Customer Drawing

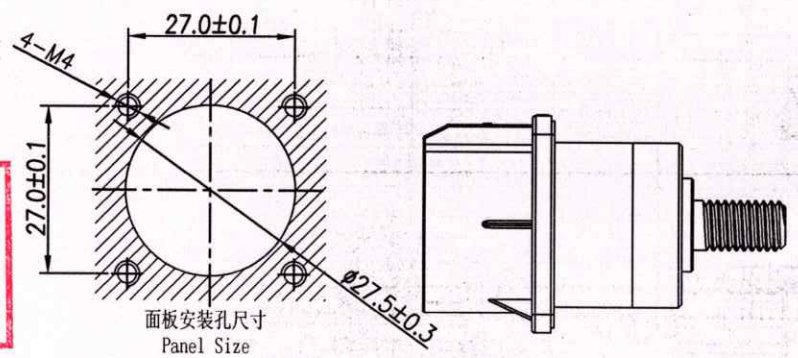
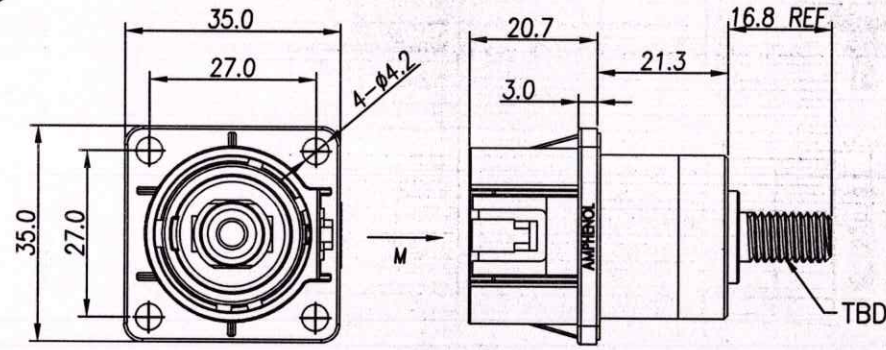

Amphenol TPI
2018-08-22
REGISTERED COPY

REVISIONS					
REV	ZONE	ECO	DESCRIPTION	DATE	BY APPR
A	---	---	Add dimensions	---	RW EC
C	---	---	Add recommended fasten torque on rear stud	08/13/18	RW EC
D	---	---	Change Dust Cap & Fasten Torison	06/23/18	RW GX
E	---	---	ADD T Key Model	08/01/18	ST JL

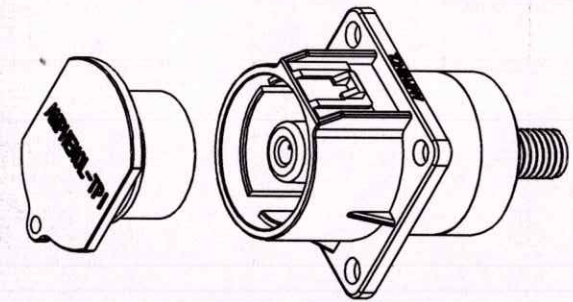

M10 Screw Standard Part List

P/N	Model NO.	Polarization
AC-HA000573	PL00X-300-20M10	X
AC-HA000574	PL00Y-300-20M10	Y
AC-HA000575	PL00U-300-20M10	U
AC-HA000576	PL00V-300-20M10	V
AC-HA000577	PL00W-300-20M10	W
AC-HA001387	PL00T-300-20M10	T

M8 Screw Standard Part List

P/N	Model NO.	Polarization
AC-HA000596	PL00X-300-20M8	X
AC-HA000597	PL00Y-300-20M8	Y
AC-HA000598	PL00U-300-20M8	U
AC-HA000599	PL00V-300-20M8	V
AC-HA000600	PL00W-300-20M8	W
AC-HA001390	PL00T-300-20M8	T

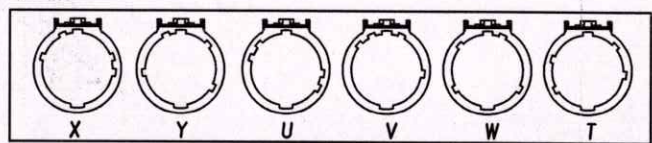

M方向键位示意图

规格参数 (Spec.):

1. 工作温度 Operating temperature: -40° C~+125° C.
2. 额定电流 Current rating: 300 A.
3. 额定电压 Operating voltage: 1000 VDC.
4. 耐电压 Dielectric withstanding voltage: 5000 VDC.
5. 防护等级 Protection class: IP67 & IP2X.
6. 电磁屏蔽 Shielding.
7. 机械寿命 Mating cycle: 500 Min.
8. 带自动二次锁扣 Automatic secondary lock.
9. 铜排推荐安装扭矩 Recommended Fasten Torque on Rear Stud:
M6 : 3.6~4.4 Nm
M8 : 7.2~8.8 Nm
M10 : 17.1~20.9 Nm
10. 法兰盘螺丝安装扭矩 Screw Assembly Torque on Flange : 1.6~2.4 Nm

订购信息 Ordering Information

PL00 X - 300 - 20 M10

键位及颜色 Key & Color	螺纹 Thread
"X", 橙色 Orange	M10
"Y", 黑色 Black	M8
"U", 黄色 Yellow	
"V", 绿色 Green	
"W", 红色 Red	
"T", 蓝色 Blue	

	Amphenol Technical Products International GZ				
	第三角投影 THIRD ANGLE PROJECTION	页面 SHEET	幅面 SIZE	版次 REV.	比例 SCALE
签名 SIGNATURE	日期 DATE	UNLESS OTHERWISE SPECIFIED			OTHER INFO
制图 DRAWN	日期 DATE	1) All dimensions are in metric (mm).			PL00-300-20
审核 CHECKED	日期 DATE	2) Tolerances are as follows:			CLIENT PART #
批准 APPROVAL	日期 DATE	0 PL DEC ±1.00			N/A
		1 PL DEC ±0.50			CLIENT REV.
		2 PL DEC ±0.20			-
		Angles ±1°			